

# CORNER RESTORATION

NE cor.  
**CORNER** Sec. 20 **TWP** 10 S **RANGE** 31 E. **W.M.**

**ORIGINAL SURVEY BY:** Rufus S. Moore - Re-established  
 by Michael Spears Grant County  
**CONTRACT NUMBER:** Surveyor in 1908  
 382  
**CONTRACT DATE:** March 23, 1881

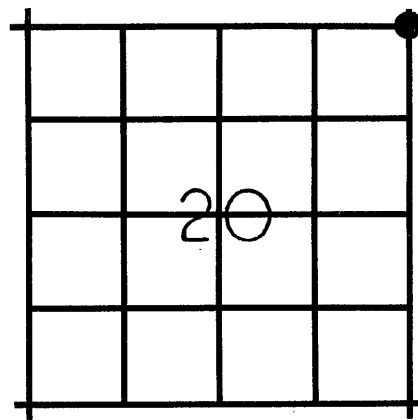

**ORIGINAL DESCRIPTION:** GLO record: Set a basalt stone 24x24x20 & dug pits for cor. to Secs. 16, 17, 20 & 21. Grant County Surveyor's record Book No. 1, Page 10 & 10A: Michael Spears Grant County Surveyor in 1908, did on July 16-20, 1908 re-establish this section corner as the original corner was lost. Spears notes state that he proportioned this corner in and set a basalt rock marked properly and a few rocks around it. From which:  
 A yellow pine 36 inch diam. bears N. 86° 45' W., 2 chains  
 A yellow pine 24 inch diam. bears S. 66° 30' W., 3.60 chains  
 A yellow pine 18 inch diam. bears S. 55° W., 4.35 chains  
 A yellow pine 20 inch diam. bears S. 53° W., 3.60 chains

**RECEIVED AND  
 FILED**

OCT 16 1985

**RESTORATION BY, STAMP AND DATE:**

R. D. Bagett  
 J. L. Watson

REGISTERED  
 PROFESSIONAL  
 LAND SURVEYOR

*Robert D. Bagett*  
 OREGON  
 JULY 12, 1933  
 ROBERT D. BAGETT  
 598

OFFICE OF COUNTY SURVEYOR

*Robert D. Bagett*  
 Attest: *Dominic Laurance*

Oct. 9, 1985

Grant County Surveyor.

**EVIDENCE FOUND:** Found Spears corner: A basalt stone 12x9x7 inches marked with 3 grooves and letters CS on South face and 4 notches on East edge, firmly set in ring of stone, from which Spears BT's.  
 A yellow pine stump, 36" diam. bears N. 88° W., 131.4 ft. No marks remain  
 A yellow pine stump, 18" diam. bears S. 54° W., 284.0 ft. No marks remain  
 A yellow pine stump, flush with ground, 20" diam. with remains of tree rotting bears S. 52½° W., 234.0 ft., with one piece of the old blaze scribed B with a knife. C

I found no trace of the other BT at record distance  
 Measured to center of old BTs - True Bearings - (Solar obs.)

**DESCRIPTION OF MONUMENTS AND ACCESSORIES SET AND METHODS USED:**

Show how trees are scribed and basis of bearings, including compass var.

In place of Spears corner stone: Set a 1½"x30" galvanized iron pipe 28 inches in the ground with brass cap marked as shown:

**MONUMENT MARKED**

From which I scribe NEW BEARING TREES:

- A juniper 8 ins. diam. bears N. 12½° E., 186.0 ft. mkd. T10SR31E S16 CSBT.
- A juniper 9 ins. diam. bears N. 24½° E., 189.5 ft. mkd X CSBT.
- A juniper 17 ins. diam. bears N. 86½° W., 155.8 ft., mkd. T10SR31E S17 CSBT, this tree is on East bank of small creek.
- A juniper 8 ins. diam. bears S. 60° W., 151.4 ft. mkd. T10SR31E S20 CSBT.

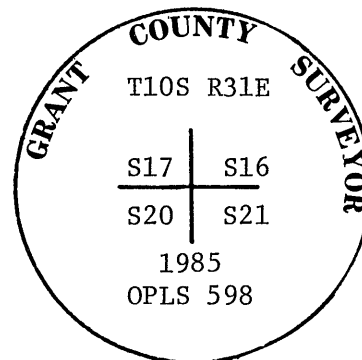

Buried Spears corner stone South and alongside iron pipe and surrounded pipe with mound of stone, 3 ft. base, to top of cap.  
 Used Wild T-2 theodolite & electronic distance measuring device MAC-II.  
 Used true (solar obs.) bearings. Distance measured to a 40d nail driven in side center of new BT's at root crown.  
 Painted BT blazes with red timber marking paint and attached County Surveyor tags to BT's.